



Hinged Door Enclosures

ENC-DED***-BK

Description:

Hinged Door Enclosures are made from ABS HB material to IP65 standard and come complete with a steel back plate, mounting wall brackets, lock and key. They come in eight sizes with a solid door, they can be used in various environments including coastal conditions, dry dusty environments and in heavy humidity.

Features:

- Designed to meet protection and combustible standards IP65 and IK08
- Available in eight sizes
- Supplied in Black with solid door and base unit
- Come complete with Steel back plate, Mounting Brackets & Key
- Wall thickness on the range is 3 - 3.5mm
- Made from UL approved ABS-HB flame retardant plastic
- Comply with the following standards: EN 60439-1, EN 62208, CEI 23-48, CEI 23-49
- Perform within a temperature range of -20° to +85°C
- Suitable for use in sea salt air conditions and dry dust environments



Dimensions:

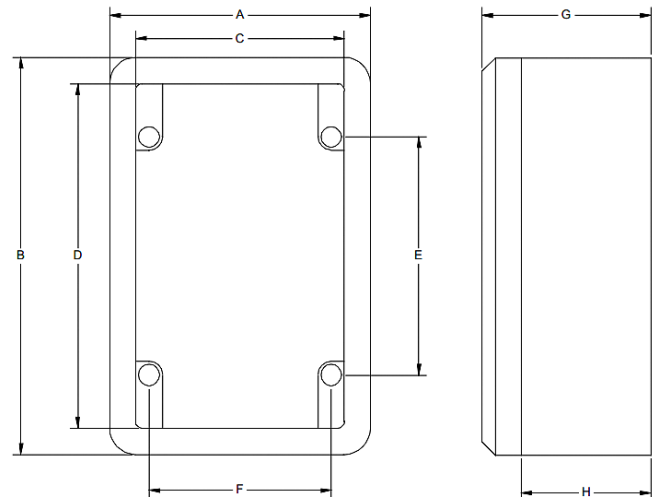

Order Codes:

ENC-DED001-BK	Enclosure 200x300x130 Solid Door
ENC-DED002-BK	Enclosure 250x350x150 Solid Door
ENC-DED004-BK	Enclosure 300x400x170 Solid Door
ENC-DED005-BK	Enclosure 300x400x220 Solid Door
ENC-DED006-BK	Enclosure 350x500x190 Solid Door
ENC-DED007-BK	Enclosure 400x500x240 Solid Door
ENC-DED008-BK	Enclosure 400x600x200 Solid Door
ENC-DED010-BK	Enclosure 500x700x250 Solid Door

Size	200x300x130	250x350x150	300x400x170	300x400x220	350x500x190	400x500x240	400x600x200	500x700x250
Model	ENC-DED001	ENC-DED002	ENC-DED004	ENC-DED005	ENC-DED006	ENC-DED007	ENC-DED008	ENC-DED010
A	200	250	300	300	350	400	400	500
B	300	350	400	400	500	500	600	700
C	143	195	245	241	291	341	341	443
D	250	300	357	348	448	448	548	650
E	177	227	277	277	377	377	477	577
F	130	180	230	230	280	330	330	430
G	130	150	170	220	190	240	200	250
H	119	139	159	209	179	229	189	239

EC Products Limited

EC House, Amberley Way, Hounslow,
Middlesex. TW4 6BH. United Kingdom
Tel:+44 (0)20 8569 4100 Fax: +44 (0)20 8569 4111